

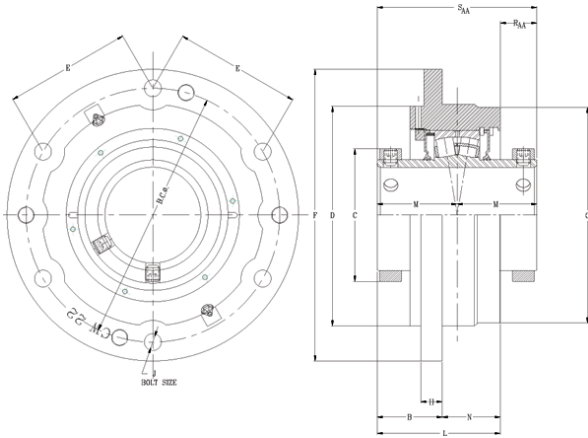

SNR BEARING CORP.OF AMERICA



timken QAACW22A408S Solid Block/Spherical Roller Bearing Housed Units-Double Concentric Piloted Flange Cartridge

Bearing No. QAACW22A408S

QAACW22A408S Bearing 2D drawings and 3D CAD models

Engineering Group	Mounted Bearing
Shaft Size	4-1/2 in
Shaft Size Type	Imperial
Full Timken Part Number	QAACW22A408SB
Locking Style	Double Concentric
Weight	72 lb
Housing Style	Piloted Flange Cartridge
UPC Code	0883450305860
Dimension BC	11.75 in
Dimension C	6.300 in
Dimension E	5.88 in
Dimension B Fix	2.44 in
Dimension B Exp	2.52 in
Dimension F	13.50 in
Dimension D	10.00 in
Dimension H	1.00 in
Dimension J (Bolt Size)	0.75 in
Dimension M	3.13 in
Dimension G	10.250 in
Dimension L Exp	5.20 in
Dimension L Fix	5.12 in
Dimension N	2.69 in
Dimension RAA	1.13 in
Dimension SAA	6.25 in
C0 - Static Load	147000 lb



SNR BEARING CORP.OF AMERICA

C - Dynamic Load (Basic)	125000 lb
e - Geometry Factor	0.25
Y1 - Geometry Factor	2.73
Y2 - Geometry Factor	4.06
Oil Lubrication - M/N Seal	900 rpm
Oil Lubrication - T Seal	1700 rpm
Oil Lubrication - B/C/O Seal	600 rpm
Grease Lubrication - M/N Seal	900 rpm
Grease Lubrication - T Seal	1200 rpm
Grease Lubrication - B/C/O Seal	600 rpm
Float	0.083 in
Shaft Tolerance	0.0050 in
Eng Internal Radial Clearance - Min	0.0030
Eng Internal Radial Clearance - Max	0.0047
Pre Install Clearance Min	0.0030 in
Pre Install Clearance Max	0.0047 in