

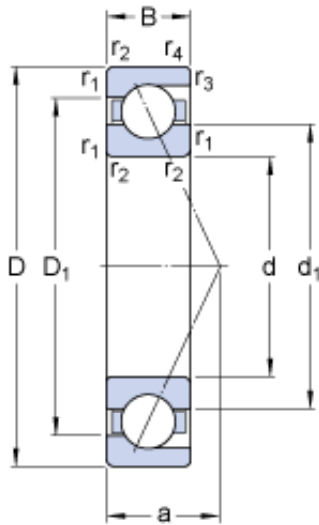

SNR BEARING CORP.OF AMERICA



420 mm x 560 mm x 65 mm skf 71984 BM
Single row angular contact ball bearings

Bearing No. 71984 BM

71984 BM Bearing 2D drawings and 3D CAD models

Size	560x420x65 mm
Bore Diameter	560 mm
Outer Diameter	420 mm
Width	65 mm
d	420 mm
D	560 mm
B	65 mm
d ₁	472 mm
D ₁	507 mm
a	238 mm
r _{1,2} - min.	4 mm
r _{3,4} - min.	1.5 mm
d _a - min.	435 mm
D _a - max.	545 mm
D _b - max.	553 mm
r _a - max.	3 mm
r _b - max.	1.5 mm
Basic dynamic load rating - C	364 kN
Basic static load rating - C ₀	670 kN
Fatigue load limit - P _u	13.7 kN
Reference speed	1200 r/min
Limiting speed	1200 r/min
Calculation factor - k _r	0.085
Calculation factor - k _a	0.7



SNR BEARING CORP.OF AMERICA

Calculation factor - e	1.14
Calculation factor - X	0.35
Calculation factor - Y_0	0.26
Calculation factor - Y_1	
Calculation factor - Y_2	0.57
d_1	472 mm
D_1	507 mm
$r_{1,2}$ min.	4 mm
$r_{3,4}$ min.	1.5 mm
d_a min.	435 mm
D_a max.	545 mm
D_b max.	553 mm
r_a max.	3 mm
r_b max.	1.5 mm
Basic dynamic load rating C	364 kN
Basic static load rating C_0	670 kN
Fatigue load limit P_u	13.7 kN
Calculation factor A	7.93
Calculation factor k_r	0.085
Calculation factor e	1.14
Calculation factor X	0.35
Calculation factor Y_0	0.26
Calculation factor Y_2	0.57
Mass bearing	44.5 kg